



18V BRUSHLESS

# TRIM ROUTER

## INSTRUCTION MANUAL

### SPECIFICATIONS

Input:	18V
No Load Speed:	10,000 - 30,000/min
Collet Size:	6.35mm & 8mm
Max. Cutter Size:	28mm
Dust Port Size:	Ø35mm
Weight:	1.84kg

[ozito.com.au](http://ozito.com.au)

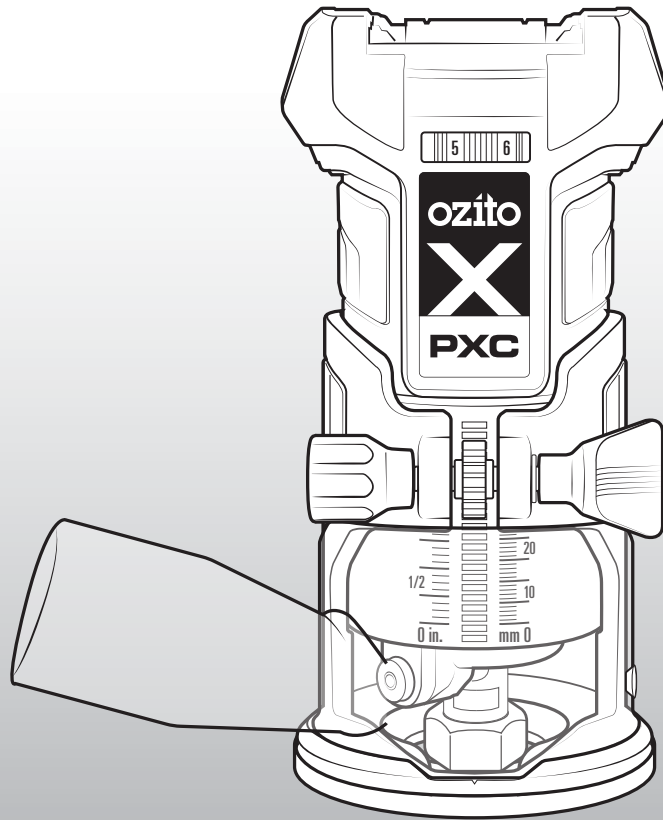

### STANDARD EQUIPMENT



Brushless Trim Router

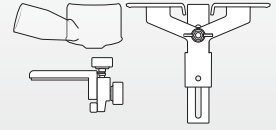

Dust Extraction Port, Parallel Guide & Trimmer Guide

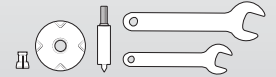

8mm Collet, Template Guide Bushing, Compass Point & 2 x Spanners (22 & 13mm)

**5 YEAR**  
REPLACEMENT WARRANTY

**PXBLTS-018**

## WARRANTY

IN ORDER TO MAKE A CLAIM UNDER THIS WARRANTY YOU MUST RETURN THE PRODUCT TO YOUR NEAREST BUNNINGS WAREHOUSE WITH YOUR BUNNINGS REGISTER RECEIPT. PRIOR TO RETURNING YOUR PRODUCT FOR WARRANTY PLEASE TELEPHONE OUR CUSTOMER SERVICE HELPLINE:

**Australia 1800 069 486**

**New Zealand 0508 069 486**

TO ENSURE A SPEEDY RESPONSE PLEASE HAVE THE MODEL NUMBER AND DATE OF PURCHASE AVAILABLE. A CUSTOMER SERVICE REPRESENTATIVE WILL TAKE YOUR CALL AND ANSWER ANY QUESTIONS YOU MAY HAVE RELATING TO THE WARRANTY POLICY OR PROCEDURE.

### WARNING

The following actions will result in the warranty being void.

- If the tool has been operated on a supply voltage other than that specified on the tool.
- If the tool shows signs of damage or defects caused by or resulting from abuse, accidents or alterations.
- Failure to perform maintenance as set out within the instruction manual.
- If the tool is disassembled or tampered with in any way.

The benefits provided under this warranty are in addition to other rights and remedies which are available to you at law.

Our goods come with guarantees that cannot be excluded at law. You are entitled to a replacement or refund for a major failure and for compensation for any other reasonably foreseeable loss or damage. You are also entitled to have the goods repaired or replaced if the goods fail to be of acceptable quality and the failure does not amount to a major failure.

Generally you will be responsible for all costs associated with a claim under this warranty, however, where you have suffered any additional direct loss as a result of a defective product you may be able to claim such expenses by contacting our customer service helpline above.

### 5 YEAR REPLACEMENT WARRANTY

Your Product is guaranteed for a period of 60 months from the original date of purchase and is intended for DIY (Do It Yourself) use only. If a product is defective it will be replaced in accordance with the terms of this warranty. **Lithium Ion batteries and chargers are covered by a 36 month warranty** and are excluded from the warranty extension. Warranty excludes consumable parts.

# KNOW YOUR PRODUCT

## BRUSHLESS TRIM ROUTER

- |                          |                          |
|--------------------------|--------------------------|
| 1. Lock Off Switch       | 9. Spindle               |
| 2. On/Off Switch         | 10. Spindle Nut          |
| 3. Sure Grip Handle      | 11. Spindle Lock         |
| 4. Battery Seating       | 12. Dust Extraction port |
| 5. Speed Control Dial    | 13. Height Adjustor      |
| 6. Trim Router Base      | 14. Guide Mount Screw    |
| 7. Depth Fastening Screw | 15. Baseplate            |
| 8. Cut Depth Scale       | 16. Clear Safety Guard   |

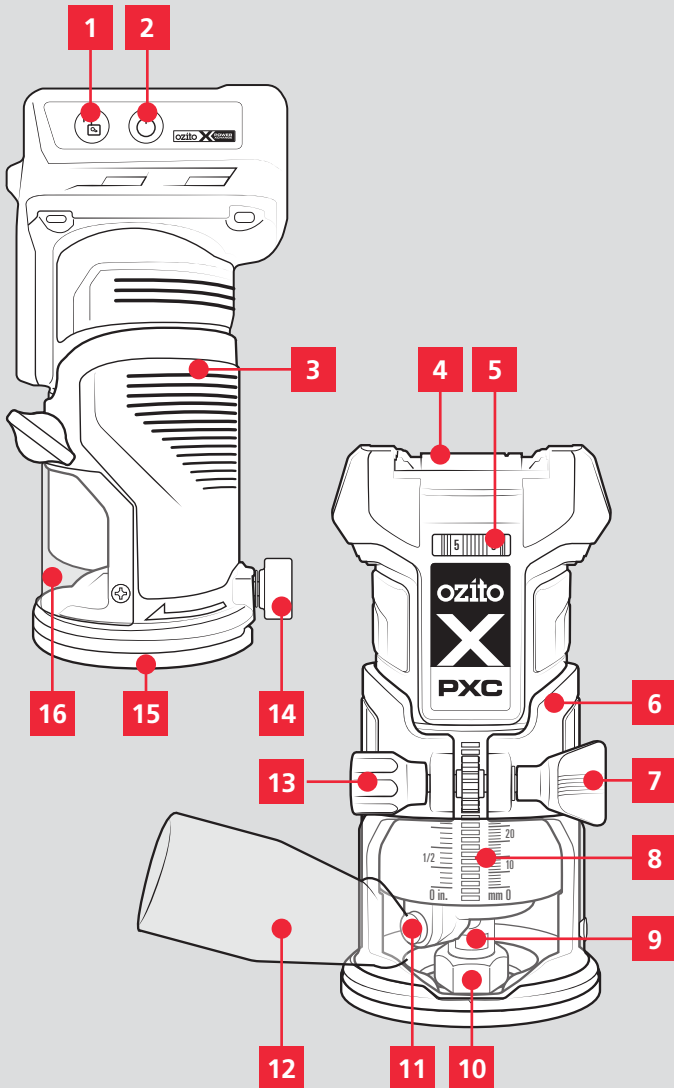

## BATTERY & CHARGER

This tool is compatible with all batteries & chargers from the Ozito PXC range.

For optimal performance, we recommend the use of a 3.0Ah battery or higher to operate this PXC Trim Router.

### ONLINE MANUAL

Scan this QR Code with your mobile device to take you to the online manual.



**5 YEAR**  
REPLACEMENT WARRANTY

# SETUP & PREPARATION

## 1. ASSEMBLY

**WARNING!** ENSURE THE TOOL IS SWITCHED OFF AND THE BATTERY IS REMOVED BEFORE PERFORMING ANY OF THE FOLLOWING TASKS.

**WARNING!** WEAR GLOVES WHEN HANDLING ROUTER BITS AS THEY CAN BE SHARP AND/OR HOT TO THE TOUCH AFTER USE.

**WARNING!** ONLY USE THE ROUTER UNIT WITH A COMPATIBLE BASE. USING IT WITHOUT A BASE OR WITH AN INCOMPATIBLE BASE MAY RESULT IN SERIOUS INJURY.

### Installing A Router Bit

When using the trim router, only use router bits that:

- are suitable for cutting wood or plastic,
- has a suitable shank diameter for the collet mounted (collet size: 6.35mm & 8mm),
- has a maximum diameter of 28mm,
- are suitable for the router's speed ( $n_0 = 10,000-30,000/\text{min}$ ).

1. Remove the trim router base from the router unit.

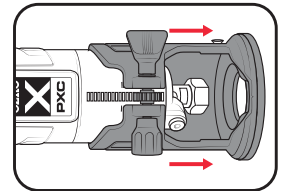

2. Place the smaller supplied spanner on the spindle and use the large spanner to loosen the collet nut.

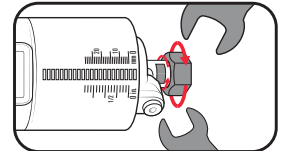

**Note:** If a different collet size is required, remove the collet nut entirely and replace the collet. Re-attach the collet nut but don't tighten it all the way.

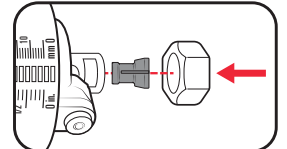

3. Fully insert the shaft of the router bit (not supplied) into the collet.

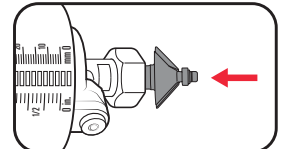

4. Press and hold down the spindle lock while tightening the collet nut with your fingers.

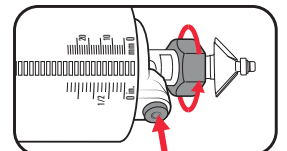

5. Release the spindle lock and then use the 2 spanners to fully tighten the collet nut.



**WARNING!** THE SPINDLE LOCK IS NOT ALLOWED TO BE USED FOR TIGHTENING WITH THE SPANNER. TIGHTEN THE CLAMP NUT USING THE TWO SPANNERS.

**5 YEAR**  
REPLACEMENT WARRANTY

## 2. EDGE TRIMMING



**WARNING!** NEVER USE THE TRIM ROUTER WITHOUT THE SAFETY GUARD FITTED.

### Attaching The Safety Guard

1. Use a screwdriver (not supplied) to remove the screw on the trim router base.

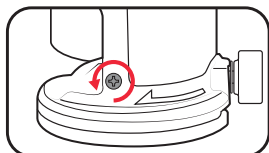

2. Slide the safety guard into position and replace the screw to lock it in place.

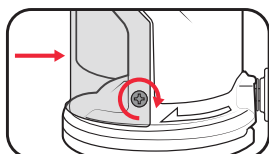

### Attaching & Removing The Trim Router Base

1. Loosen the depth fastening screw.

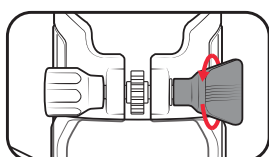

2. Slide the router into the router base.

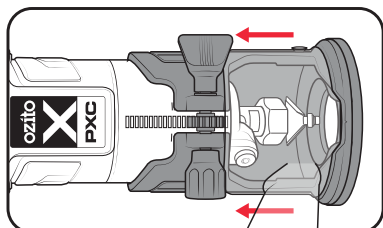

3. Tighten the depth fastening screw.

4. To remove the base, loosen the depth fastening screw and pull the base off the router.

### Fitting A Battery

1. Slide the battery into the tool base until it clicks into place.

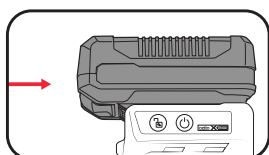

2. Hold down the battery release button and then slide the battery out.

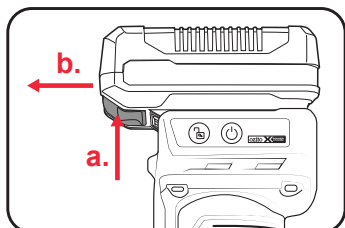

### Attaching The Trimmer Guide

The trimmer guide allows you to trim off precise amounts of material from the edge of a workpiece.

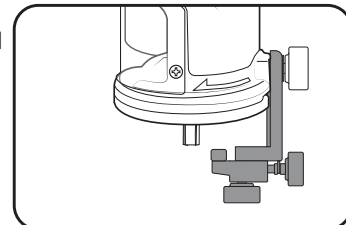

1. Loosen the guide mount screw.

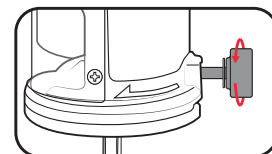

2. Slide the trimmer guide arm between the washer and router base.

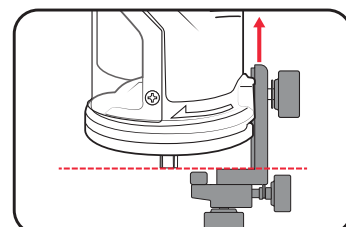

**Note:** The height of the trimmer guide should be just below the router bit when it is completely lowered.

3. Tighten the guide mount screw to lock the guide in place.

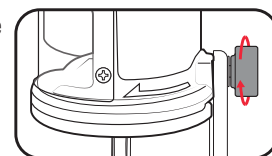

### Adjusting The Trimmer Guide

1. Loosen the trimmer locking bolt.

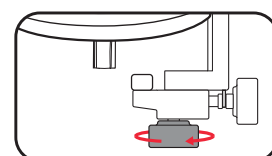

2. Adjust the trim depth by rotating the horizontal adjustment knob. Rotate the knob clockwise for a larger trim.

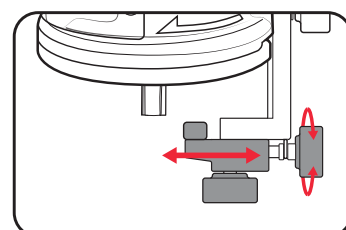

3. Tighten the trimmer locking bolt to set the distance in place.

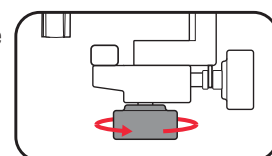

### 3. STRAIGHT CUTS

#### Attaching The Parallel Guide

The parallel guide helps to maintain a straight path when chamfering or filleting edges, filleting edges, cutting slots or grooves.

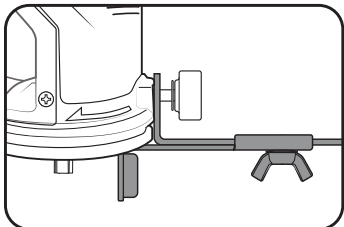

1. Loosen the guide mount screw.

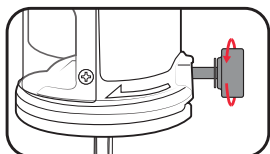

2. Slide the parallel guide arm between the washer and router base. Push it all the way up until the straight edge is flush with the trimmer base.

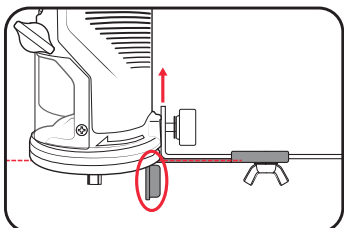

3. Tighten the guide mount screw to lock the guide in place.

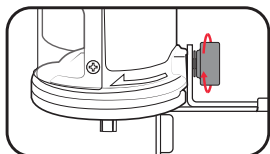

#### Adjusting The Parallel Guide

1. Loosen the fence locking wingnut.

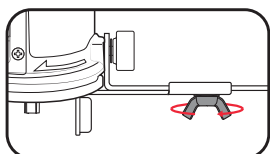

2. Place the fence along the side of the workpiece.

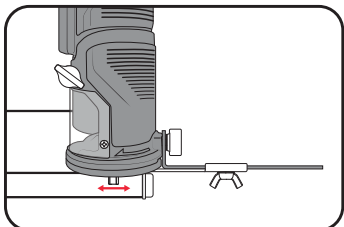

3. Set the cutting distance by sliding the trim router to the desired cutting position.

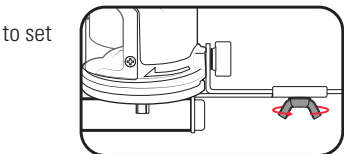

4. Tighten the fence locking wingnut to set the distance in place.

### 4. CUTTING CIRCLES

#### Attaching The Compass Point

The compass point can be used to guide the router in a circular cut.

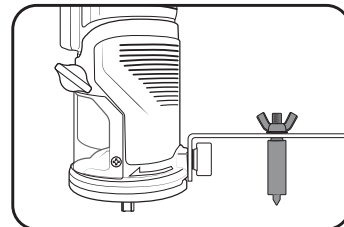

1. Undo the fence locking wingnut and remove the straight edge from the parallel guide.

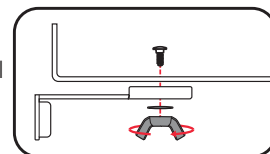

2. Attach the compass point to the parallel guide with the washer and wingnut, ensuring the compass point is parallel to the short arm of the parallel guide.

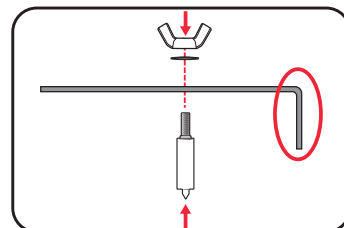

3. Loosen the guide mount screw on the trim router base.

4. Slide the parallel guide arm between the washer and router base, ensuring that the compass point is facing downwards.

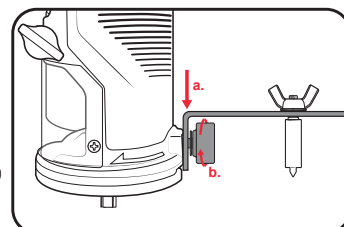

5. Tighten the guide mount screw to lock the guide in place.

#### Adjusting The Compass Point

1. Loosen the fence locking wingnut.



2. Move the compass point along the fence to the required radius from the cutter.

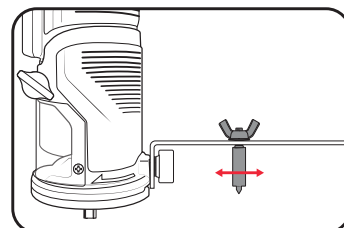

3. Tighten the wingnut to lock the compass point in place.

4. Place the compass point into the material at the centre of the circle you wish to cut.

# OPERATION

## 5. USING A TEMPLATE

### Fitting The Template Guide Bushing

The template guide allows you to cut multiple copies of a pattern by following the contours of a template piece. Template pieces should be 8mm thick to work with the guide bushing.

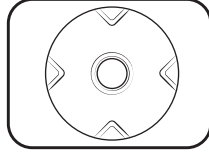

1. Undo the four screws on the bottom of the trim router base with a screwdriver (not supplied) and remove the baseplate.

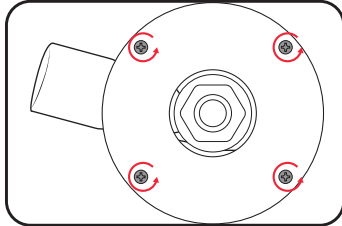

2. Insert the template guide into the cutout in the upper plate of the safety guard.

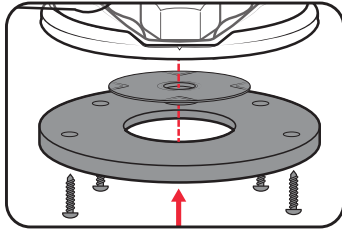

3. Replace the baseplate and refasten the screws to secure the guide in place.

### Using The Template Guide Bushing

1. Secure your chosen template against the workpiece so that it doesn't shift during use.
2. Place the guide bushing against the side of the template.

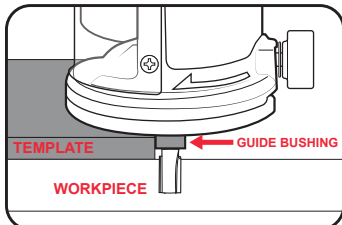

**Note:** Ensure that the router bit chosen has a shank long enough to pass through the guide bushing and cut through the workpiece.

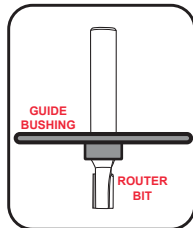

3. Follow the procedures for routing, keeping the guide bushing pressed against the contours of the template.

## 6. CONTROLS

### Adjusting The Cutting Height

1. Loosen the depth fastening screw.

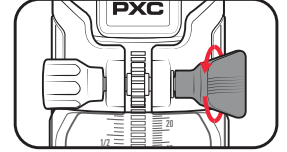

2. Slide the trim router base to the desired cutting depth, using the measuring scale as a guide.

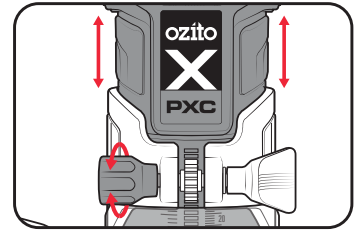

3. Use the depth adjuster for micro adjustments to the cutting height.

4. Tighten the depth fastening screw to lock the setting in place.

### Adjusting The Cutting Speed

The cutting speed needs to be adjusted based on the router bit profile and type of material being cut. Always test new settings on a piece of scrap before tackling your workpiece.

1. Rotate the speed control dial to the desired setting.

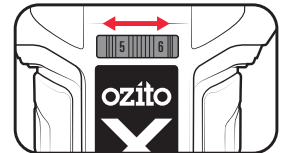

If the speed is too low, the router bit may overheat and burn the workpiece. If the speed is too high, you may damage the cutting edge on the router bit and cause rough, uneven cuts.

## Switching The Tool On & Off

The router has a safety lock off function that needs to be disengaged before the tool can be started.

1. Press the lock off switch to disengage the function. The LED worklight will switch on.
2. Press the on/off switch to start the tool.

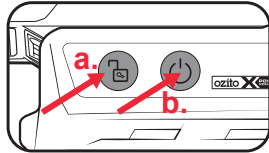

**Note:** The lock off function will automatically re-activate after 10 seconds to prevent accidental starting. The LED worklight will switch off when this happens.

3. Press the on/off switch again to stop the tool.

**WARNING!** ALLOW THE ROUTER BIT TO COME TO A STANDSTILL BEFORE REMOVING IT FROM THE WORKPIECE AND/OR PLACING THE ROUTER DOWN.

4. Press the lock off switch to lock the tool.

**WARNING!** TO PREVENT ACCIDENTAL START, LOCK THE TOOL BY PRESSING THE LOCK OFF SWITCH.

## 7. USAGE

**WARNING!** ALWAYS WEAR HEARING, EYE AND BREATHING PROTECTION DURING OPERATION.

**WARNING!** HOLD THE TOOL WITH BOTH HANDS DURING OPERATION AND KEEP FINGERS CLEAR OF THE ROUTER BIT AT ALL TIMES. INJURY MAY OCCUR IF YOU HOLD THE TRIMMER INCORRECTLY.

1. Perform the steps below before starting

- Ensure that the correct router bit is installed.
- Ensure that the trim router base and router bit is secure and correctly installed.
- Check that the cut depth and speed are correctly set.
- Check that any accessories being used are securely and correctly attached.
- Connect a dust extraction unit, such as a vacuum cleaner, to the dust extraction port to create a cleaner work environment.
- Clamp or secure the workpiece so that it does not move during routing.
- Check for and remove any metal parts (eg. nails, screws, staples etc.) that may come into contact with the router bit.

2. Place the trimmer guide base onto the workpiece so that the router bit overhangs the edge.

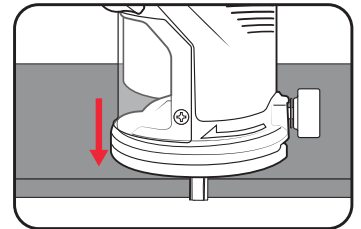

3. Press the lock-off button and then the on/off switch to start the tool.

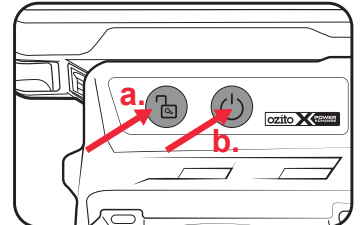

4. Allow the router bit to reach full speed before moving it into the workpiece.
5. Follow the guide below when cutting around your workpiece. This

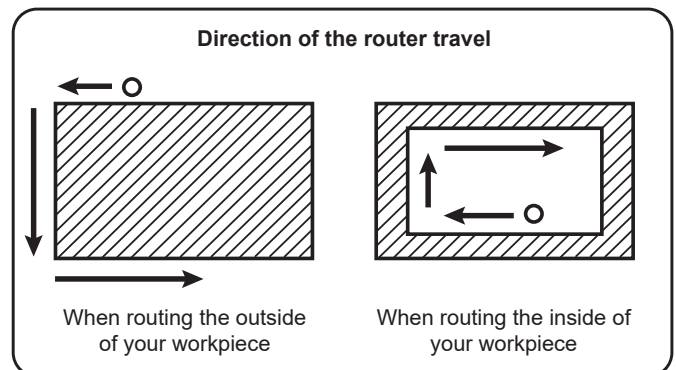

ensures that wood chips and debris are removed away from you as you cut.

**Note:** For deeper cuts or harder timbers, making several shallow progressive cuts will allow for better control over the tool and a neater finish.

# TROUBLESHOOTING

## Router not cutting or removing material

The router bit may be blunt or damaged.  
Try again with a new or sharpened router bit.

The speed setting may be too low, overheating and burning instead of cutting the material.  
Increase the speed setting and try again.

The motor may be overloaded  
Reduce excessive force on the trimmer and let the tool do the work of removing material.

## Router cuts are rough or uneven







The router bit may be blunt or damaged.  
Try again with a new or sharpened router bit.

The speed setting may be too high.  
Reduce the speed setting and try again.

## Router is vibrating excessively

The router bit shaft may be bent.  
Replace the router bit and try again.

# DESCRIPTION OF SYMBOLS

<b>V</b>	Volts	<b>mm</b>	Millimetres
<b>/min</b>	Revolutions per minute	<b>n<sub>0</sub></b>	No load speed
	Do not dispose in general waste		Direct current
	Warning		Wear hearing, eye and breathing protection
	Read Instruction Manual		Regulatory Compliance Mark (RCM)

# MAINTENANCE



**WARNING!** BEFORE CLEANING OR CARRYING OUT ANY MAINTENANCE PROCEDURE, ENSURE THAT THE BATTERIES HAVE BEEN REMOVED.

## Cleaning

- Keep the ventilation slots of the tool clean at all times to ensure efficient operation.
- After each use, blow air through the tool housing to ensure it is free from all dust, dirt, etc. Build up of dust or dirt particles may cause the tool to overheat and shorten the life of the tool.
- If the housing of the tool requires cleaning, do not use solvents. Use of a cloth only is recommended.
- Never allow any liquid to get inside the tool, never immerse any part of the tool into liquid.

## Storage

When not in use, the tool should be stored in a dry, frost free location, keep out of children's reach.

**Note:** Ozito Industries will not be responsible for any damage or injuries caused by repair of the tool by an unauthorised person or by mishandling.

# CARING FOR THE ENVIRONMENT



Power tools that are no longer usable should not be disposed of with household waste but in an environmentally friendly way. Please recycle where facilities exist. Check with your local council authority for recycling advice.



Recycling packaging reduces the need for landfill and raw materials. Reuse of recycled material decreases pollution in the environment. Please recycle packaging where facilities exist. Check with your local council authority for recycling advice.

# SPARE PARTS

Spare parts can be ordered from the Special Orders Desk at your local Bunnings Warehouse.

For further information, or any parts not listed here, visit [www.ozito.com.au](http://www.ozito.com.au) or contact Ozito Customer Service:

Australia 1800 069 486

New Zealand 0508 069 486

E-mail: [enquiries@ozito.com.au](mailto:enquiries@ozito.com.au)

# ELECTRICAL SAFETY

 **WARNING!** Read the whole manual carefully and make sure you know how to switch the tool off in an emergency, before operating the tool.  
Save these instructions and other documents supplied with this tool for future reference.

Refer to the PXC battery and charger manuals for information regarding charging, use and storage.

# GENERAL POWER TOOL SAFETY WARNINGS

 **WARNING!** Read all safety warnings, instructions, illustrations and specifications provided with this power tool. Failure to follow all instructions listed below may result in electric shock, fire and/or serious injury.

Save all warnings and instructions for future reference.

The term "power tool" in the warnings refers to your mains-operated (corded) power tool or battery-operated (cordless) power tool.

## 1) Work area safety

- Keep work area clean and well lit. Cluttered or dark areas invite accidents.
- Do not operate power tools in explosive atmospheres, such as in the presence of flammable liquids, gases or dust. Power tools create sparks which may ignite the dust or fumes.
- Keep children and bystanders away while operating a power tool. Distractions can cause you to lose control.

## 2) Electrical safety

- Power tool plugs must match the outlet. Never modify the plug in any way. Do not use any adapter plugs with earthed (grounded) power tools. Unmodified plugs and matching outlets will reduce risk of electric shock.
- Avoid body contact with earthed or grounded surfaces, such as pipes, radiators, ranges and refrigerators. There is an increased risk of electric shock if your body is earthed or grounded.
- Do not expose power tools to rain or wet conditions. Water entering a power tool will increase the risk of electric shock.
- Do not abuse the cord. Never use the cord for carrying, pulling or unplugging the power tool. Keep cord away from heat, oil, sharp edges or moving parts. Damaged or entangled cords increase the risk of electric shock.
- When operating a power tool outdoors, use an extension cord suitable for outdoor use. Use of a cord suitable for outdoor use reduces the risk of electric shock.

## 3) Personal safety

- Stay alert, watch what you are doing and use common sense when operating a power tool. Do not use a power tool while you are tired or under the influence of drugs, alcohol or medication. A moment of inattention while operating power tools may result in serious personal injury.
- Use personal protective equipment. Always wear eye protection. Protective equipment such as a dust mask, non-skid safety shoes, hard hat or hearing protection used for appropriate conditions will reduce personal injuries.
- Prevent unintentional starting. Ensure the switch is in the off-position before connecting to power source and/or battery pack, picking up or carrying the tool. Carrying power tools with your finger on the switch or energising power tools that have the switch on invites accidents.
- Remove any adjusting key or wrench before turning the power tool on. A wrench or a key left attached to a rotating part of the power tool may result in personal injury.
- Do not overreach. Keep proper footing and balance at all times. This enables better control of the power tool in unexpected situations.
- Dress properly. Do not wear loose clothing or jewellery. Keep your hair and clothing away from moving parts. Loose clothes, jewellery or long hair can be caught in moving parts.
- If devices are provided for the connection of dust extraction and collection facilities, ensure these are connected and properly used. Use of dust collection can reduce dust-related hazards.
- Do not let familiarity gained from frequent use of tools allow you to become complacent and ignore tool safety principles. A careless action can cause severe injury within a fraction of a

second.

## 4) Power tool use and care

- Do not force the power tool. Use the correct power tool for your application. The correct power tool will do the job better and safer at the rate for which it was designed.
- Do not use the power tool if the switch does not turn it on and off. Any power tool that cannot be controlled with the switch is dangerous and must be repaired.
- Disconnect the plug from the power source and/or remove the battery pack, if detachable, from the power tool before making any adjustments, changing accessories, or storing power tools. Such preventive safety measures reduce the risk of starting the power tool accidentally.
- Store idle power tools out of the reach of children and do not allow persons unfamiliar with the power tool or these instructions to operate the power tool. Power tools are dangerous in the hands of untrained users.
- Maintain power tools and accessories. Check for misalignment or binding of moving parts, breakage of parts and any other condition that may affect the power tool's operation. If damaged, have the power tool repaired before use. Many accidents are caused by poorly maintained power tools.
- Keep cutting tools sharp and clean. Properly maintained cutting tools with sharp cutting edges are less likely to bind and are easier to control.
- Use the power tool, accessories and tool bits etc. in accordance with these instructions, taking into account the working conditions and the work to be performed. Use of the power tool for operations different from those intended could result in a hazardous situation.
- Keep handles and grasping surfaces dry, clean and free from oil and grease. Slippery handles and grasping surfaces do not allow for safe handling and control of the tool in unexpected situations.

## 5) Battery tool use and care

- Recharge only with the charger specified by the manufacturer. A charger that is suitable for one type of battery pack may create a risk of fire when used with another battery pack.
  - Use power tools only with specifically designated battery packs. Use of any other battery packs may create a risk of injury and fire.
  - When battery pack is not in use, keep it away from other metal objects, like paper clips, coins, keys, nails, screws or other small metal objects, that can make a connection from one terminal to another. Shorting the battery terminals together may cause burns or a fire.
  - Under abusive conditions, liquid may be ejected from the battery; avoid contact. If contact accidentally occurs, flush with water. If liquid contacts eyes, additionally seek medical help. Liquid ejected from the battery may cause irritation or burns.
  - Do not use a battery pack or tool that is damaged or modified. Damaged or modified batteries may exhibit unpredictable behaviour resulting in fire, explosion or risk of injury.
  - Do not expose a battery pack or tool to fire or excessive temperature. Exposure to fire or temperature above 130 °C may cause explosion.
  - Follow all charging instructions and do not charge the battery pack or tool outside the temperature range specified in the instructions. Charging improperly or at temperatures outside the specified range may damage the battery and increase the risk of fire.
- ## 6) Service
- Have your power tool serviced by a qualified repair person using only identical replacement parts. This will ensure that the safety of the power tool is maintained.
  - Never service damaged battery packs. Service of battery packs should only be performed by the manufacturer or authorized service providers.

# ROUTER SAFETY WARNINGS

 **WARNING!** The appliance is not to be used by persons (including children) with reduced physical, sensory or mental capabilities, or lack of experience and knowledge, unless they have been given supervision or instruction.

Young children should be supervised to ensure that they do not play with the appliance.

- Avoid using power tools and machines for long periods of time without breaks. Vibration from tools and machines can be transmitted into your hands and arms.
- Use clamps or another practical way to secure and support the workpiece to a stable platform. Holding the work by your hand or against the body leaves it unstable and may lead to loss of control.
- Do not point LED at eyes of persons or animals.
- Only use router bits with a shank diameter suitable for the size of the collet installed in the tool.
- Only use router bits suitable for the no-load speed of the tool.

- Do not use the tool in an inverted position.
- Do not attempt to use the tool in a stationary mode.
- Take special care when cutting MDF or surfaces coated with lead-based paint. Wear a dust mask specifically designed for protection against lead paint dust and fumes and ensure that persons within or entering the work area are also protected.