

Electric-Hedge Trimmer PH 600

Art.-No.: **34.035.95**

Bar code: **4006825531367**

Sales unit: **4 pcs**

The practical helper cut also the closest hedges easy. Silent, safe and easy handling. The drive system offers high gumption achievement and optimal wheel lock control. Safety measurers moving in opposite directions and reciprocally cutting from precision-polished special steel. The ON/OFF-two-hand safety switch ensures reliable and comfortable working.

The rear handle can be turned around to 90° and to 180°. Thus simplest handling is ensured also in difficult situations (e. g.: with cuts of the hedge “over head”)

The reciprocally mountable sword shavel which can be installed onto both sides provides with horizontal cuts for a simple evacuation of the cut property.

Features:

- **Reciprocally mountable sword shovel (1)**
- Two-hand safety switch with mechanical blade stop <0,5 sec. (2)
- **Additional switch for over head working (3)**
- Rear handle turnable to 180° (4)
- Aluminium knife cover (5)
- Safety measurers moving opposite directions and reciprocally cutting from precision-polished special steel (6)
- Impact protection with integrated holes for wall fastening (7)
- Sturdy knife protection cover for storage and transport (without picture)

Technical Data:

- Mains: 230 V ~ 50 Hz
- Power: 600 watts
- Cutting length: 530 mm
- Sword length: 600 mm
- Teeth spacing: 20 mm
- Cutting strength max.: 15 mm
- Cuts per min.: 3200
- Weight: 5.5 kg
- Packing dimensions: 1085 x 190 x 225 mm

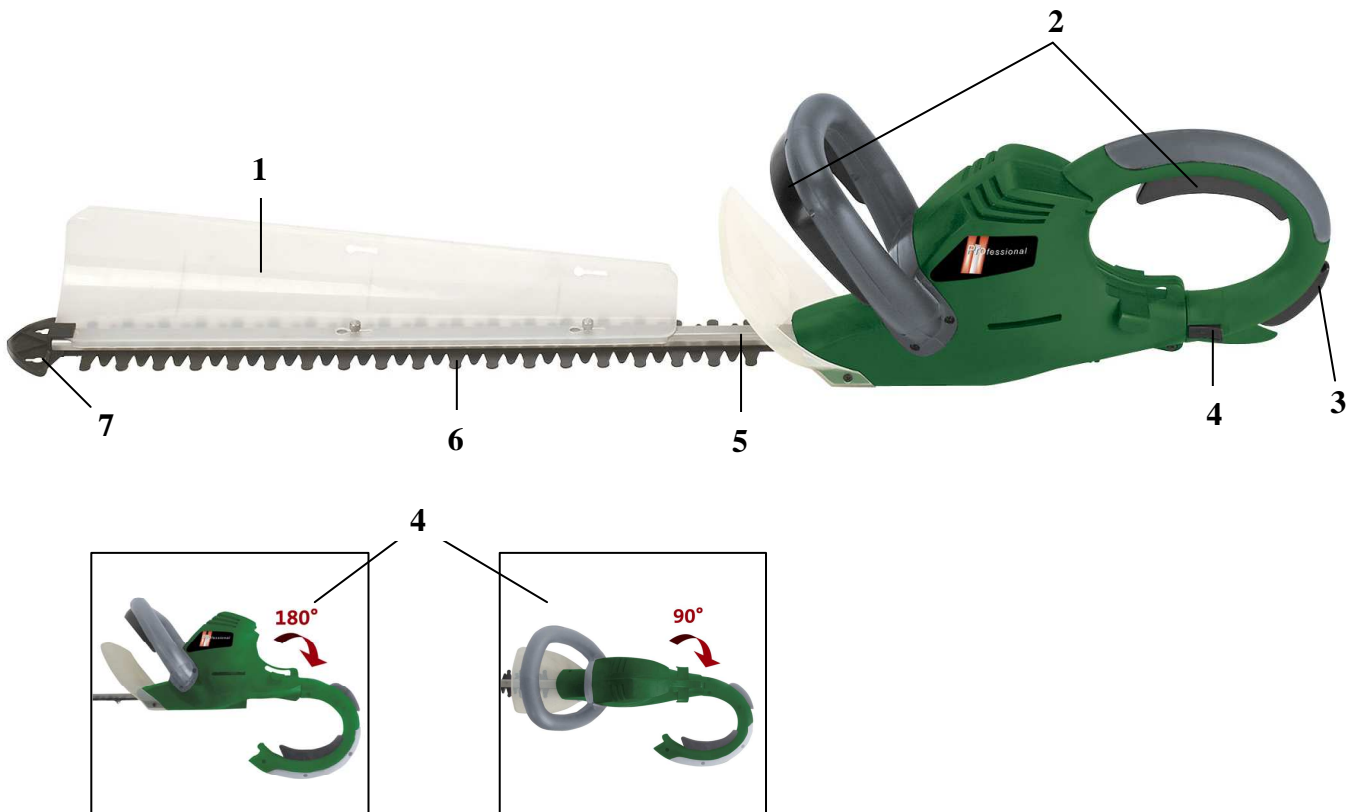

Abbildungen können nicht im Serien-Lieferumfang enthaltenes Zubehör darstellen / Illustrations can contain accessories, which are not included in standard extent of delivery.

Abbildungen ähnlich, produktionsbedingte Abweichung vorbehalten / Illustration similar (in design), production-wise modifications reserved

File: S:\shared-pool\Product-Dokumentation\T-Produktbeschreibung\30_n0t\Originale_Englisch_PA04\3403595_01016.doc

Erstelldatum / create date: 10.07.2006 18:12:00

Aktualisiert / up dated: 05.02.2009